



METALMASTER®

LIGHTNING ROD BRACKET

SOLO CLASSICA 480 AND 275
VALC PROFILE

INSTALLATION GUIDE

Solo 480 and 275/Valc profile — lightning rod bracket

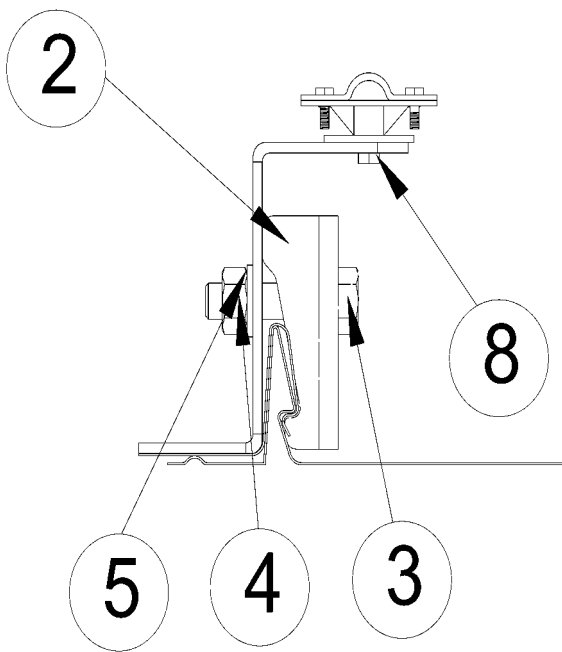
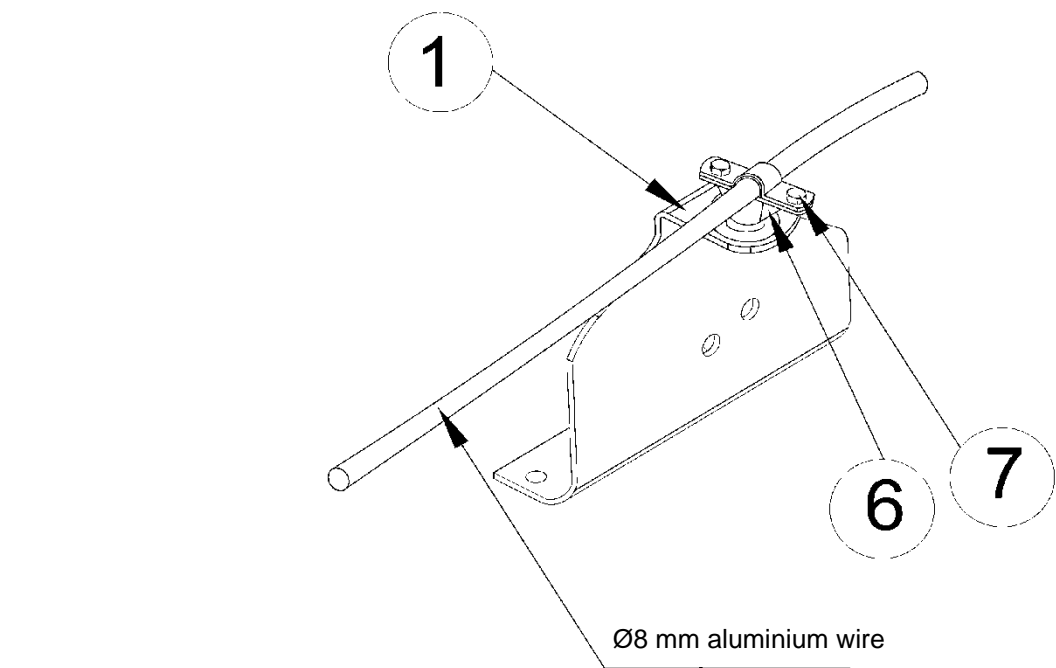

SOLO/VALC lightning rod installation kit		Kit
Pos.	Name	Quantity
1.	Bracket Z-plate	1*
2.	RP-bracket	2*
3.	M8x35 screw	2*
4.	M8 nut	2*
5.	M8 washer	2*
6.	Lightning rod wire fastener	1*
7.	M6x12 screw	2*
8.	M8x20 screw	1*

* Quantity depends on the number of kits.

Lightning rod installation

- Plan the location for installation.
 - Make sure that the roof structure is stable.
 - The lightning rod Z-bracket plate must be installed on top of the roof battens.
 - Check to confirm that the roofing is installed according to the roof installation instructions.
 - Install the Z-bracket plates on one side of the roof seam (Figure 1).
 - Place the RP-bracket on the other side of the seam (Figure 1).
 - Make sure that the Z and RP-bracket parts are in the position shown in the figure (Figure 2).
 - Screw together using an M8x35 mm bolt screw, M8 nut, and washer (Figure 1).
 - Tighten the screws such that the Z-bracket plate holds firmly on the roof material (Figure 1).
 - Install the lightning rod wire fasteners on top of the Z-bracket plate and screw them together using the M8x20 screw (Figure 1).
 - Insert the aluminium wire into the lightning rod wire holder, securing it with two M6x12 screws (Figure 3).
-

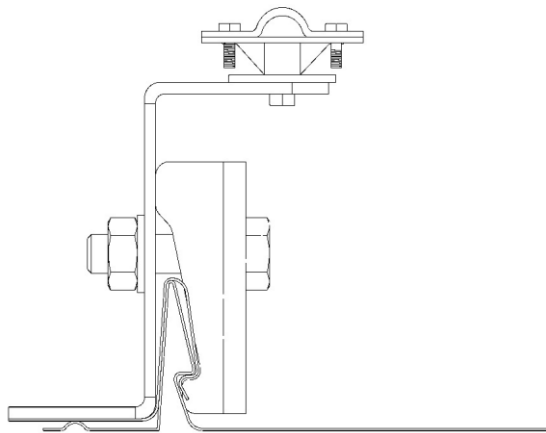

Figure 1.

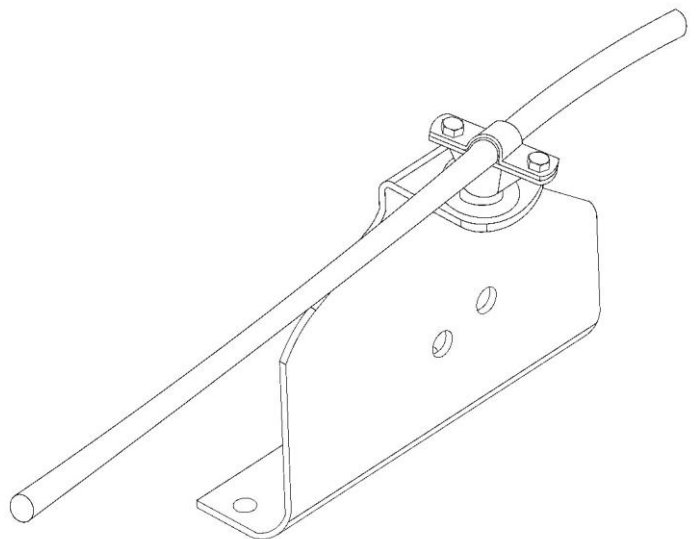

Figure 2.